

Care cots for children

...the original!



Assembly Instructions
for your new **Timmy** - care cot



Rieper Straße 12
D-29683 Dorfmark
Telefon: +49 5163 / 290044
Telefax: +49 5163 / 290049
www.kayserbetten.de
info@kayserbetten.de

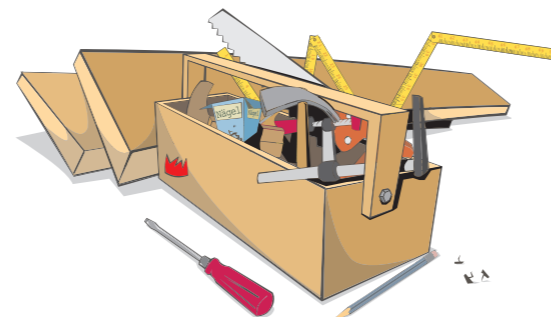

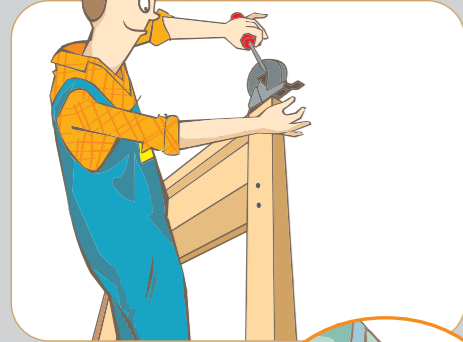

These are our mechanics
Robert and Stefan.
They will help you
to assemble your KayserBed!



Assembly Instructions for your new **Timmy** - care cot

The assembly must be on a level surface.

If your bed is equipped with a set of castors then please screw them first into the holes drilled under the side frames (drawing left above).

Please lay the architraves ④ + ⑤ on the ground in order to push in the transverse nuts ⑩. Now screw in the threaded bars ⑪.

Set up one side frame ①. At first, install the first architrave ⑤ by putting it with the threaded bars through the lower drilled holes of the side frame. The wooden pegs must fit properly into the drilled holes. Then bolt the architrave with a brass cap ⑫. Now, the construction stands steady already!

Install the second lower architrave ⑤.

Now the apertures ⑥ have to be put into the grooves of the installed architraves, then insert the upper architraves ④ with the threaded bars into the upper drilled holes of the side frame. The batten needs to be inside at the bottom. Screw the architraves with two brass caps each.

The second side frame ① has to be pushed onto the 6 remaining threaded bars of the architraves and securely tightened.



The bed is now ready so that the sleeping platform ⑭ can be inserted. At first, take the control units out of the packaging. Then you need a second person to help with the sleeping platform. To avoid pinching your fingers, hold it from the inside. The sleeping platform needs to be led carefully between the side frames and is laid down onto the wooden strips of the architraves.

(If your cot is electronically adjustable, then please make sure that the cables are underneath in order to avoid them being trapped. Install the switch box ⑮ with the screws provided ⑱ on the left or right exterior of a side frame (out of reach of the patient). For further information concerning the sleeping platform, please read the enclosed operating instructions.)

Now the 4 lowerable cot sides ② + ③ should be inserted from above. By pulling the bolting device inward, the cot sides can be lowered to different heights.

Place the four ornament heads ⑦ onto the corner posts and your new Timmy-cot is ready to use.

Parts list and explosion views of your de votre new **Timmy** - care cot

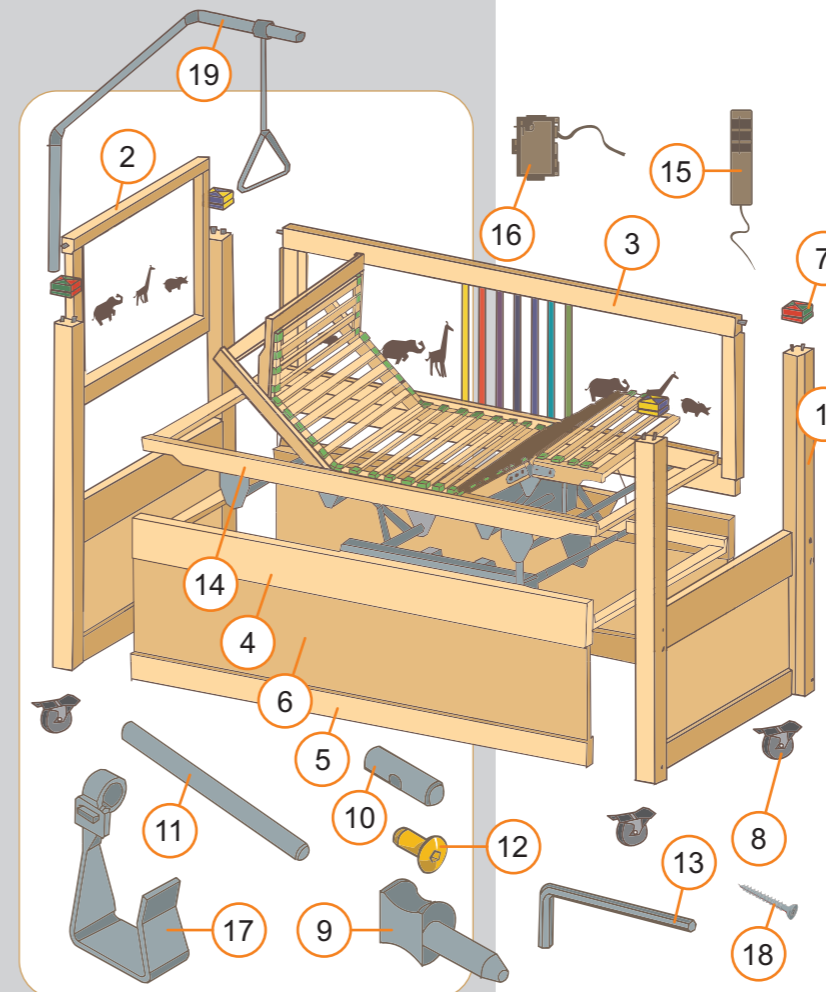

Pos.	Qty.	Designation
Wooden surround		
1	2	side frame
2	2	lowerable cot side, short
3	2	lowerable cot side, long
4	2	connecting architrave 150mm
5	2	connecting architrave 90mm
6	2	aperture
7	4	ornament head
8	4	castors
Fittings		
9	4	plug-in pegs
10	12	transverse nuts
11	12	threaded bars M8x140mm
12	12	brass caps
13	1	allen key
Sleeping platform		
14	1	sleeping platform with slatted frame
15	1	manual control switch*
16	1	security switch box*
17	1	mounting for power cable*
18	2	screws for switch box*
*(only with electronic sleeping platform)		
Optional		
19	1	lifter