

Parts list and explosion views of your new **I da** bed

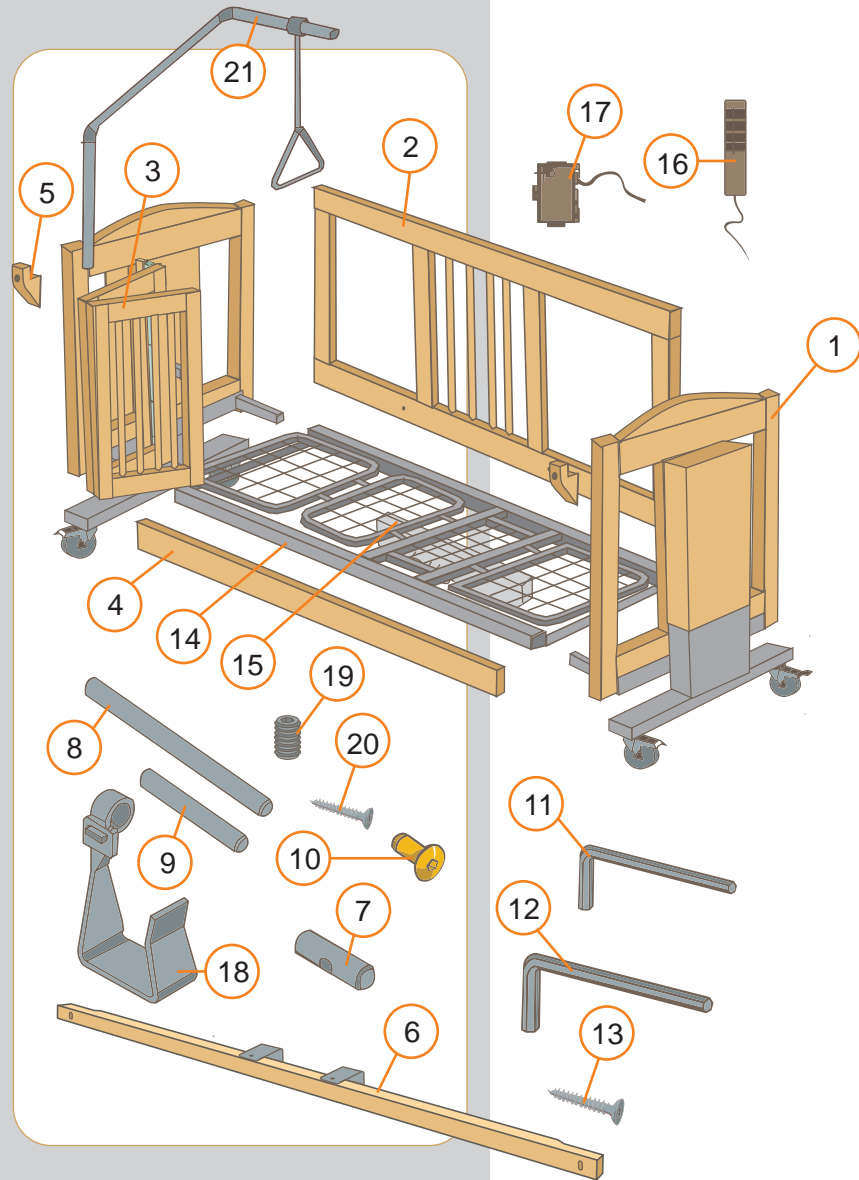

Pos.	Qty.	Designation
Wooden surround		
1	2	side frame
2	1	back part
3	2	folding doors
4	1	connecting architraves 120mm
5	4	consoles for door security system
6	1	bar for door security system
Fittings		
7	6	transverse bolts
8	6	threaded pins M8x110 mm
9	4	threaded pins M8x 60 mm
10	10	brass caps
11	1	allen key small
12	1	allen key big
13	4	screws 4,5 x 50 mm
Sleeping platform		
14	1	lying surface
15	1	motor for lying surface
16	1	hand control
17	1	security switching box
18	1	mounting for main cable
19	8	grub screws (premounted in the lying surface)
20	3	screws for switching box
Optional		
21	1	lifter

KayserBetten
SECURE SLEEP SYSTEM

... the original!



Assembly Instructions for your new **I da** – care bed (4 doors)

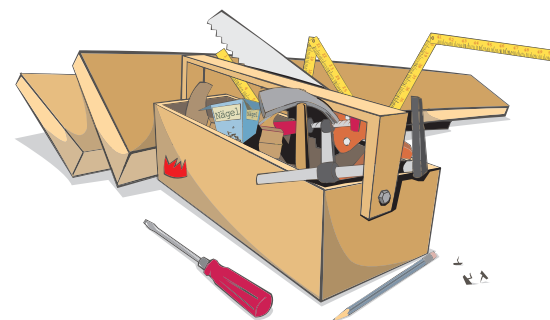

KayserBetten

Rieper Straße 12
29683 Dorfmark
Germany

Telefon: +49 5163 / 6595
Telefax: +49 05163 / 2076

Internet: www.kayserbetten.de
E-mail: info@kayserbetten.de

These are our mechanics Robert and Stefan. They will help you to assemble your KayserBed.



Assembly Instructions for your new **Ida** – care bed

The assembly must be on a level surface.

Please put the frame (4) and the back part (2) on the ground in order to push in the transverse bolts (7). Now screw in the threaded pins (8).

Set up one side frame (1) and push the lying surface onto the side frame (14).

Install the back part (2) by putting the threaded pins through the lower drilled holes of the side frame. The wooden pegs must fit properly into drillings. After this, bolt the back part with a brass cap at (10) the side frame. Now screw with the aluminium slide rail upward and the curve downward to the side frame. Now screw the other frame (4) with the aluminium slide rail upward and the curve downward to the side frame.

Set up the second side frame, so that the frames (4), the back part (2) and the sleeping platform can be hung in. Secure this connection with loosely screwed brass caps (10).

Secure all threaded pins with brass caps. In order to avoid tilting, first screw all of the brass caps on one side and then those on the other side.

Now adjust the sleeping platform between the side frames so that there is equal space on both sides. The sleeping platform is now ready to be screwed with the side frames from below by using grub screws (19) (these are prescrewed onto the sleeping platform). Now screw the front frame and the back part with 2 (13) screws from the inside with the lying surface.

After screwing the threaded pins (9) into the assembly strips of the folding doors you should insert them with the lower guide pin into the aluminium profile of the architrave (frame). Then push it against the side frame. Finally, screw the threaded pins with 2 brass caps (10).

Optional:

For mounting the locking bar, please put the console (5) in the drilled hole of the corner post on the head and foot side, adjust them and then secure this connection with screws.

Please put the first dowel on one side of the locking bar (6) in the console (5) of the corner post, then the second on the other side. The sheet metal overlaps the door slot

You can lock the bar by pushing the (wine red) knob on the right and left side in the console. The bed is now locked.

To unlock the bed, please put the security knob out of the consoles.

Your new IDA bed is now completely assembled and ready to use.

